



# JACKING BEAMS

## SG15-1



Easy for Ram Moving

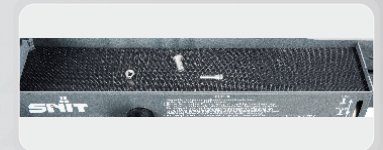

Spare Parts Tray with Rubber Mat



Easy for Frame Moving



Pneumatic Power Set with Condensate Separator and Compressed Air Connections

Model	Capacity	Working Air Pressure	Stroke	Min Height	Max Height	Width L1	Depth	Total Weight	L1 Option
SG15-1	15t	0.75-1.2Mpa	800mm	1020mm	1820mm	600-1400mm	665mm	280kg	600-880mm
									840-1140mm
									1100-1400mm

### SG15-1

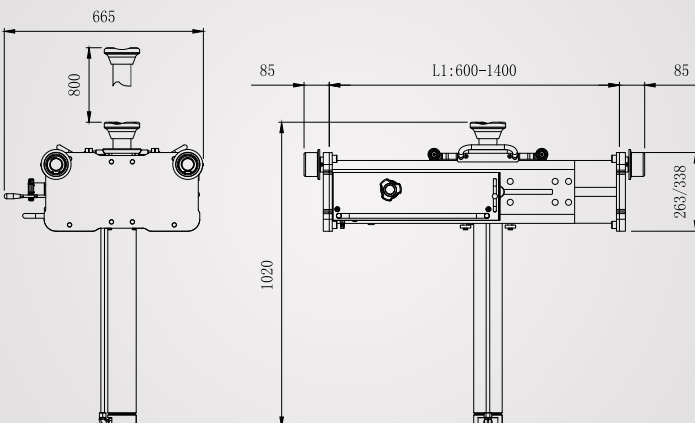

## Features

- Standard air hydraulic single ram pit jack
- Rapid and precise air hydraulic unit with high speed ram travel
- Slow down valve
- Self-return switch for safe working
- Frame height is adjusted and set to the customers individual specifications
- Can be made to fit all lifts due to its adjustable frame
- Comprehensive option range: cross beam, gearbox saddle, support bridge etc
- Fitted with leaf spring support bearings for easy glide transversing ram



# OPTION FOR THE JACKING BEAM & PIT JACKS

## A1-1

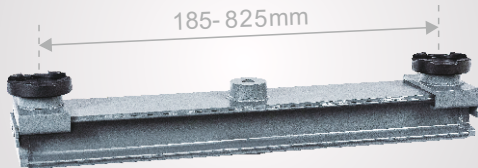

### Cross beam adaptor

Capacity: 20t

Offers increased safety-divides the load over 2 lifting points

Ideal for supporting axle, whilst allowing work to be done on the different gear

Increases min height by 97mm

Usable with various extensions and saddles: A5 A6 A7 A8

Fits:

SG15-1

## A1-2

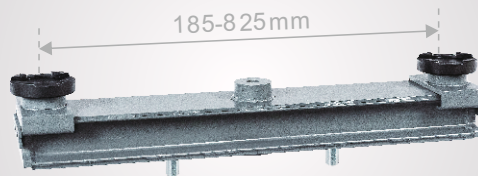

### Cross beam adaptor

Capacity: 20t

Offers increased safety-divides the load over 2 lifting points

Ideal for supporting axle, whilst allowing work to be done on the different gear

Increases min height by 147mm

Usable with various extensions and saddles: A5 A6 A7 A8

Fits:

SJ20-2 SG20-2

## A2-1

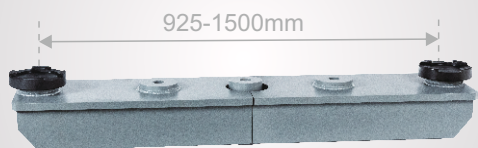

### Cross beam adaptor

Capacity: 11-15t

Offers increased safety-divides the load over 2 lifting points

Ideal for supporting axle, whilst allowing work to be done on the different gear

Increases min height by 94mm

Usable with various extensions and saddles: A5 A6 A7 A8

Fits:

SG15-1

## A2-2



### Cross beam adaptor

Capacity: 11-15t

Offers increased safety-divides the load over 2 lifting points

Ideal for supporting axle, whilst allowing work to be done on the different gear

Increases min height by 144mm

Usable with various extensions and saddles: A5 A6 A7 A8

Fits:

SJ20-2 SG20-2

## Application Scenarios



## Application Scenarios





# OPTION FOR THE JACKING BEAM & PIT JACKS

**A5**



**V-saddle**

Capacity:10t  
Suitable for lifting under various axles  
Fits:  
SG15-1 SJ15-1 SJ20-2 SG20-2

**A6**

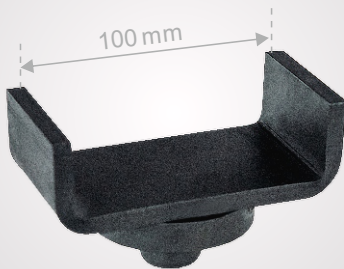

**U-saddle**

Capacity:10t  
Suitable for lifting various chassis profiles  
Fits:  
SG15-1 SJ15-1 SJ20-2 SG20-2

**A7**



**Extension-A7**

Capacity:10t  
Height:100mm  
Increases the lifting height by 100mm  
Fits:  
SG15-1 SJ15-1 SJ20-2 SG20-2

**A8**



**Extension-A8**

Capacity:10t  
Height:200mm  
Increases the lifting height by 200mm  
Fits:  
SG15-1 SJ15-1 SJ20-2 SG20-2

**Application Scenarios**



**Application Scenarios**





# OPTION FOR THE JACKING BEAM & PIT JACKS

**A4**

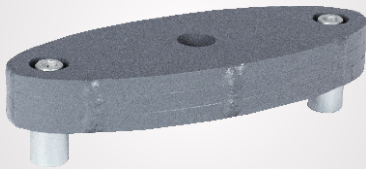

**Diff beam**

Capacity: 20t  
Allows use of both rams to lift at one point  
Fits:  
SJ20-2 SG20-2

**Application Scenarios**



**A9-1**



**Integrated safety stand**

Capacity: 20t  
Mechanical locking of the load prevents unintended lowering  
Adjustable in 10 positions  
Increases the minimum height of the pit jack by 45mm  
Fits:  
SG15-1

**Application Scenarios**



**A9-2**



**Integrated safety stand**

Capacity: 10t  
Mechanical locking of the load prevents unintended lowering  
Adjustable in 5 positions  
Increases the minimum height of the pit jack by 15mm  
Fits:  
SJ20-2

**Application Scenarios**



**A9-3**



**Integrated safety stand**

Capacity: 10t  
Mechanical locking of the load prevents unintended lowering  
Adjustable in 10 positions  
Increases the minimum height of the pit jack by 15mm  
Fits:  
SG20-2