

RS30 WL

10" - 30"
RIM STRAIGHTENING MACHINE
WITH LATHE



TECHNICAL SPECIFICATIONS

Rim Diameters	10" - 30"
Hydraulic Engine	0,55kW 900 d/d rpm 1h
Mechanic Engine	0,55kW 900 d/d rpm 1h
3 phase - single phase	380V -(optional 220V)
Length	1200mm
Width	800mm
Height	1600mm
Weight	430kg
Hydraulic Pump Power	5 ton

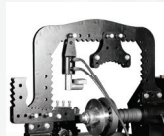

OH650
Pro Type
Top Frame
Adapter



GVS560
Hydraulic Gear
Valve Set With
3 Cylinder



HFM850
Steel Halfmoon
Repair Adapter
Set 8pcs



MMP120
Magnetic Gauge



PLUG220
220V Electric
Plug Output

STANDARD ACCESSORIES



DH120
Digital
Thermometer



SCU 435
Speed Control
Unit



HFM 250
2pcs
Halfmoon Set



GLPEN
Gold Lathe Pen



1pc Manual Head
Repair Tool



3pcs
Lengthening
Tools

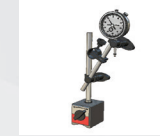

MMP90
Magnetic Gauge
Tool Holder

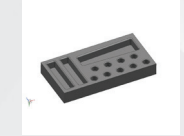

Plastic Tool
Holder



5pcs Bolt, Nut
and Conical
Adapter Set



Easy 40
Easy
Rim Connecting
Adapter



18pcs
Rim Centering
Adapters



1 Set
Lathe Tool



5pcs
Straightening
Heads



2pcs
Allen Keys



1pc
Manuel Gauge
Tool



HS280
Infrared Heating
System