

Grupa HRB

Pokrętła

ze stalowym trzpieniem gwintowanym

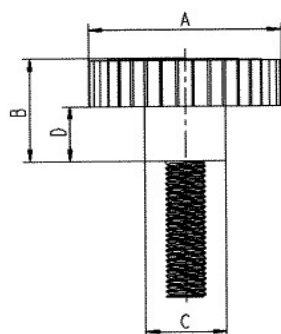
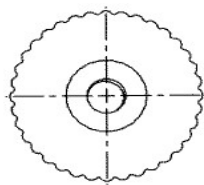

Materiał: PA, stal
Kolory standardowe: czarny

Numer katalog.	Średnica gabarytowa	Wysokość uchwytu	Średnica powierzchni dociskowej	D	Gwint
	A [mm]	B [mm]	C [mm]		
76722201	22	15,0	13,0	5,0	M5 x 10
76722202	22	15,0	13,0	5,0	M5 x 15
76722203	22	15,0	13,0	5,0	M5 x 20
76722204	22	15,0	13,0	5,0	M5 x 25
76722205	22	15,0	13,0	5,0	M5 x 30
76722206	22	15,0	13,0	5,0	M6 x 10
76722207	22	15,0	13,0	5,0	M6 x 15
76722208	22	15,0	13,0	5,0	M6 x 20
76722209	22	15,0	13,0	5,0	M6 x 25
76722210	22	15,0	13,0	5,0	M6 x 30
76723001	30	17,0	15,0	6,0	M5 x 10
76723002	30	17,0	15,0	6,0	M5 x 15
76723002	30	17,0	15,0	6,0	M5 x 20
76723002	30	17,0	15,0	6,0	M5 x 25
76723002	30	17,0	15,0	6,0	M5 x 30
76723002	30	17,0	15,0	6,0	M6 x 10
76723002	30	17,0	15,0	6,0	M6 x 15
76723002	30	17,0	15,0	6,0	M6 x 20
76723002	30	17,0	15,0	6,0	M6 x 25
76723002	30	17,0	15,0	6,0	M6 x 30
76723002	30	17,0	15,0	6,0	M6 x 35
76723002	30	17,0	15,0	6,0	M6 x 40
76723002	30	17,0	15,0	6,0	M8 x 15

Średnica

Numer katalog.	Średnica gabarytowa	Wysokość uchwytu	powierzchni dociskowej	D [mm]	Gwint
	A [mm]	B [mm]	C [mm]		
76723002	30	17,0	15,0	6,0	M8 x 20
76723002	30	17,0	15,0	6,0	M8 x 25
76723002	30	17,0	15,0	6,0	M8 x 30
76723002	30	17,0	15,0	6,0	M8 x 35
76723002	30	17,0	15,0	6,0	M8 x 40
76724001	40	22,0	19,0	9,0	M6 x 10
76724001	40	22,0	19,0	9,0	M6 x 15
76724001	40	22,0	19,0	9,0	M6 x 20
76724001	40	22,0	19,0	9,0	M6 x 25
76724001	40	22,0	19,0	9,0	M6 x 30
76724001	40	22,0	19,0	9,0	M6 x 40
76724001	40	22,0	19,0	9,0	M8 x 15
76724001	40	22,0	19,0	9,0	M8 x 20
76724001	40	22,0	19,0	9,0	M8 x 25
76724001	40	22,0	19,0	9,0	M8 x 30
76724001	40	22,0	19,0	9,0	M8 x 35
76724001	40	22,0	19,0	9,0	M8 x 40
76725001	50	30,0	21,0	16,0	M8 x 15
76725001	50	30,0	21,0	16,0	M8 x 20
76725001	50	30,0	21,0	16,0	M8 x 25
76725001	50	30,0	21,0	16,0	M8 x 30
76725001	50	30,0	21,0	16,0	M8 x 35
76725001	50	30,0	21,0	16,0	M8 x 40
76725001	50	30,0	21,0	16,0	M10 x 15
76725001	50	30,0	21,0	16,0	M10 x 20
76725001	50	30,0	21,0	16,0	M10 x 25
76725001	50	30,0	21,0	16,0	M10 x 30
76725001	50	30,0	21,0	16,0	M10 x 35
76725001	50	30,0	21,0	16,0	M10 x 40