

Najbardziej zaawansowane urządzenie diagnostyczne do programowania kluczy i pilotów samochodowych

C E N N I K



Smart PRO jest urządzeniem diagnostycznym firmy Advanced Diagnostics Ltd służącym do programowania kluczy oraz pilotów samochodowych. Jest to technologicznie najbardziej zaawansowane rozwiązanie dostępne dla klientów z branży zabezpieczeń i elektroniki samochodowej. Smart PRO wyposażone jest w programy obsługujące większość systemów producentów aut na świecie.



| Nowe urządzenie | Cena |
|--|------------|
| Smart Pro - wersja bazowa (3 miesiące UTP, 12 programów) | 19 990 PLN |
| Smart Pro Light - wersja bazowa (1 miesiąc UTP) | 14 990 PLN |

| Wymiana | Cena |
|--|------------|
| MVP/AD100 Pro - urządzenia, które były zarejestrowane po 15.05.2017 (3 miesiące UTP, 12 programów) | 9 890 PLN |
| MVP/AD100 Pro - urządzenia, które były zarejestrowane pomiędzy 01.07.2015 a 14.05.2017 (3 miesiące UTP, 12 programów) | 10 990 PLN |
| MVP/AD100 Pro - urządzenia, które były zarejestrowane przed 30.06.2015 (3 miesiące UTP, 12 programów) | 14 990 PLN |
| MVP/AD100 Pro - urządzenia, które były zarejestrowane przed 30.06.2015 Wersja Light (1 miesiąc UTP) | 10 990 PLN |

| Pakiety tokenów | Cena regularna |
|-----------------|----------------|
| 25 tokenów | 1890 PLN |
| 50 tokenów | 3390 PLN |
| 100 tokenów | 5790 PLN |
| 250 tokenów | 9490 PLN |



| Pakiety czasowe | Cena regularna |
|------------------------|-----------------------|
| 1 miesiąc | 990 PLN |
| 3 miesiące | 2590 PLN |
| 6 miesięcy | 4790 PLN |
| 12 miesięcy | 7190 PLN |

| Pakiet dzienny | Cena regularna |
|---|-----------------------|
| 5 x 24H (pięć pojedynczych dni aktywowanych na żądanie) | 890 PLN |

| Ceny oprogramowania | Cena regularna |
|---|-----------------------|
| Grupa A+ | 4990 PLN |
| Grupa A | 2990 PLN |
| Grupa B | 2290 PLN |
| Grupa C | 1390 PLN |
| Opis oprogramowania dostępny poniżej | |

| Kategoria Cenowa | Symbol | Nazwa | Opis | Region |
|-------------------------|---------------|------------------|-------------------------------------|---------------|
| C | ADS2143 | BMW | BMW Mini Remote Programming | All Regions |
| A | ADS2263 | BMW2018 | BMW i Mini | All Regions |
| A | ADS2183 | BMW CAS | BMW CAS | EMEA |
| A | ADS2113 | Chrysler | CHRYSLER / JEEP | All Regions |
| C | ADS2266 | Chrysler2017 | Chrysler 2017 | All Regions |
| A | ADS2272 | Chrysler2018 | Chrysler 2018 | All Regions |
| A | ADS2291 | Chrysler2019 | CHRYSLER 2019 | All Regions |
| B | ADS2173 | ChryslerCAN2010 | Chrysler / JEEP FOBIK 2010 | All Regions |
| A | ADS2156 | ChryslerCANII | Chrysler / JEEP CAN BUS 2,3,4 and 5 | All Regions |
| A | ADS2178 | ChryslerProx2011 | Chrysler / JEEP FOBIK 2011 | All Regions |
| A | ADS2195 | ChryslerProx2013 | Dodge 2013 | |
| A+ | ADS2234 | ChryslerProx2014 | Jeep/Chrysler/Fiat 2016 | All Regions |
| A | ADS2157 | ChryslerSkim | Chrysler Skim PIN Code Read | All Regions |
| A | ADS2259 | Dacia2017 | Dacia 2017 | EMEA |
| A | ADS2119 | Daewoo | Daewoo | All Regions |
| C | ADS2176 | Daihatsu | Daihatsu | EMEA |

| Kategoria Cenowa | Symbol | Nazwa | Opis | Region |
|------------------|---------|----------------------|---|---------------|
| A | ADS2121 | Fiat | Fiat / Alfa / Lancia | All Regions |
| A | ADS2168 | Fiat2008 | Fiat / Alfa / Lancia 2008 | EMEA |
| A | ADS2185 | Fiat2012Pin | Fiat Pin Read | All Regions |
| C | ADS2231 | Fiat2015 | Fiat 2015 | All Regions |
| A | ADS2247 | Fiat2015SAM | Fiat 2015 (SAM) | EMEA |
| A | ADS2258 | Fiat2016 | Fiat 2016 | All Regions |
| A | ADS2295 | Fiat2019 | ALFA ROMEO - FIAT - JEEP 2019 | All Regions |
| A | ADS2100 | Ford | Ford | All Regions |
| A | ADS2257 | Ford2016 | Ford 2016 | All Regions |
| A+ | ADS2269 | Ford2019 | Ford 2019 | All Regions |
| A | ADS2133 | FordCoded | Ford Coded | All Regions |
| A | ADS2162 | FordCoded2 | Ford Coded 2007 | All Regions |
| A | ADS2222 | FordCoded2014 | Ford Coded 2014 | EMEA |
| C | ADS2271 | FordFalcon2018 | Ford Falcon 2018 | EMEA |
| C | ADS2190 | FordParamReset | Ford Parameter Reset | All Regions |
| C | ADS2275 | FordRangerAus | Ford Ranger 8C read transponder information | EMEA |
| B | ADS2172 | FordUSA2010 | Ford USA 2010 | All Regions |
| B | ADS2175 | FordUSA2011 | Ford USA 2011 | All Regions |
| A | ADS2209 | FordUSA2013 | Ford USA 2013 | All Regions |
| A | ADS2102 | GeneralMotors | General Motors | All Regions |
| A | ADS2279 | GM2018KeyProgramming | GM 2018 KEY PROGRAMMING | All Regions |
| B | ADS2290 | GM2020 | | All Regions |
| C | ADS2130 | GMCAN | General Motors CAN BUS | All Regions |
| B | ADS2171 | GMCANPincode | GM CAN Pin | All Regions |
| A | ADS2139 | GMCANUSA | GM CAN USA | All Regions |
| B | ADS2274 | GMEuropePincode | GM Europe Pincode | EMEA |
| A | ADS2187 | GMUSA2012 | GM 2012 | All Regions |
| A+ | ADS2223 | GMUSA2014 | GM 2014 | North America |

| Kategoria Cenowa | Symbol | Nazwa | Opis | Region |
|------------------|---------|------------------|---------------------------|---------------|
| B | ADS2282 | GMUSA2018Pincode | | North America |
| C | ADS2182 | GreatWall | Great Wall Motors | EMEA |
| A | ADS2110 | Honda | Honda / Acura | All Regions |
| B | ADS2166 | Honda2008 | Honda / Acura 2008 | All Regions |
| A | ADS2193 | Honda2012 | Honda/Acura 2013 | All Regions |
| B | ADS2118 | Hyundai | Hyundai / Kia | All Regions |
| B | ADS2196 | Hyundai2012 | Hyundai / Kia 2012 | All Regions |
| A | ADS2280 | HyundaiKia2018 | HYUNDAI KIA 2018 | All Regions |
| A | ADS2321 | HyundaiKia2020 | HyundaiKia2020 | |
| C | ADS2135 | Isuzu | Isuzu | All Regions |
| A | ADS2308 | Isuzu24V | Isuzu Truck | EMEA |
| A | ADS2136 | Iveco | Iveco | EMEA |
| A | ADS2151 | JaguarCAN | Jaguar | EMEA |
| A | ADS2207 | JLRProx | Jaguar - Land Rover 2013 | All Regions |
| A+ | ADS2284 | KEIDAIHATSU | DAIHATSU KEI CARS | EMEA |
| A+ | ADS2283 | KEIHONDA | HONDA KEI CARS | EMEA |
| A+ | ADS2285 | KEISUZUKI | SUZUKI KEI CARS | EMEA |
| C | ADS2147 | KiaCAN | Hyundai / Kia CAN | All Regions |
| A | ADS2164 | LandRover | LandRover | All Regions |
| C | ADS2108 | LDV | LDV | EMEA |
| A | ADS2225 | Mazda2014 | Mazda 2014 | All Regions |
| B | ADS2267 | Mazda2017 | Mazda 2017 | All Regions |
| C | ADS2137 | Mercedes | Sprinter | All Regions |
| B | ADS2117 | Mitsubishi | Mitsubishi | All Regions |
| B | ADS2189 | Mitsubishi2012 | Mitsubishi 2012 | All Regions |
| B | ADS2281 | Mitsubishi2017 | mitsubishi TRITON MQ 2017 | AUSTRALIA |
| A | ADS2154 | MitsubishiCAN | Mitsubishi CAN BUS | All Regions |
| A | ADS2112 | Nissan | Nissan | All Regions |

| Kategoria Cenowa | Symbol | Nazwa | Opis | Region |
|------------------|---------|---------------------|----------------------------|-------------|
| B | ADS2220 | Nissan2014 | Nissan 2014 | EMEA |
| C | ADS249 | Nissan2015SAM | Nissan 2015 SAM | EMEA |
| C | ADS2297 | Nissan2020 | NISSAN 2020 | |
| A | ADS2159 | NissanCAN | Nissan Proximity / CAN BUS | All Regions |
| C | ADS2170 | NissanPincode | Nissan Pin Code | EMEA |
| | ADS2198 | NissanPincodeADC198 | Nissan Pin Read Dongle | |
| A | ADS2197 | NissanProx2013 | Nissan 2013 | All Regions |
| B | ADS2128 | Proton | Proton | EMEA |
| A | ADS2105 | PSA | Peugeot / Citroen | EMEA |
| A | ADS2188 | PSA2012 | Peugeot / Citroen 2012 | EMEA |
| B | ADS2142 | PSACAN | Peugeot / Citroen CAN BUS | EMEA |
| A | ADS2701 | PSACoder | PSA Radio Decoder | EMEA |
| B | ADS2229 | PSAPincode2016 | PSA Pin Code Reading | EMEA |
| A | ADS2104 | Renault | Renault | EMEA |
| A | ADS2180 | Renault2011 | Renault 2011 Software | EMEA |
| A | ADS2268 | Renault2017 | Renault 2017 | EMEA |
| A | ADS2287 | Renault2019 | Renault 2019 | EMEA |
| A | ADS2106 | Rover | Rover Remote Programming | EMEA |
| B | ADS2144 | Saab | SAAB | All Regions |
| A | ADS2179 | Smart | Smart | All Regions |
| B | ADS2153 | SsangYong | Ssangyong | EMEA |
| B | ADS2127 | Subaru | Subaru | All Regions |
| C | ADS2228 | Subaru2015 | Subaru 2015 | All Regions |
| C | ADS2255 | Subaru2016 | Subaru 2016 | All Regions |
| A | ADS2286 | Subaru2018 | | All Regions |
| C | ADS2224 | SubaruProx | Subaru Proximity 2014 | EMEA |
| B | ADS2109 | Suzuki | Suzuki | EMEA |
| C | ADS2163 | SuzukiCAN | Suzuki CAN / Proximity | EMEA |
| C | ADS2233 | SuzukiCAN2015 | Suzuki 2016 | All Regions |

| Kategoria Cenowa | Symbol | Nazwa | Opis | Region |
|------------------|---------|------------|----------------------------------|---------------|
| A | ADS2125 | Toyota | Toyota Lexus | All Regions |
| A | ADS2174 | Toyota2010 | Toyota 2010 | All Regions |
| B | ADS2199 | Toyota2013 | Toyota 2013 | All Regions |
| A | ADS2227 | Toyota2015 | Toyota 2015 | All Regions |
| C | ADS2296 | Toyota2020 | Toyota 2019 | North America |
| B | ADS2150 | ToyotaCAN | Toyota Lexus 2007 | All Regions |
| A | ADS2115 | VAG | VW / AUDI / SEAT / SKODA | All Regions |
| C | ADS2186 | VAG2012 | VW / AUDI / SEAT / SKODA 2012 | EMEA |
| A | ADS2219 | VAG2013 | VAG 2013 | All Regions |
| C | ADS2230 | VAG2015 | VAG DASH 2015 | All Regions |
| A | ADS2292 | VAG2019 | VAG 2019 | All Regions |
| A | ADS2146 | VAGCAN | VW / AUDI / SEAT / SKODA CAN BUS | All Regions |
| A | ADS2261 | Volvo | Volvo | All Regions |

* wszystkie podane ceny są cenami netto, należy doliczyć do nich 23% podatku VAT.

Poniżej instrukcja jak dokładnie sprawdzić modele które występują w danym oprogramowaniu

Należy zalogować się na portalu mykeyspro.com (jeżeli jeszcze nie posiadasz konta należy się zarejestrować)

Po zalogowaniu należy przejść do zakładki Catalogue a następnie wybrać poniżej Programming Software

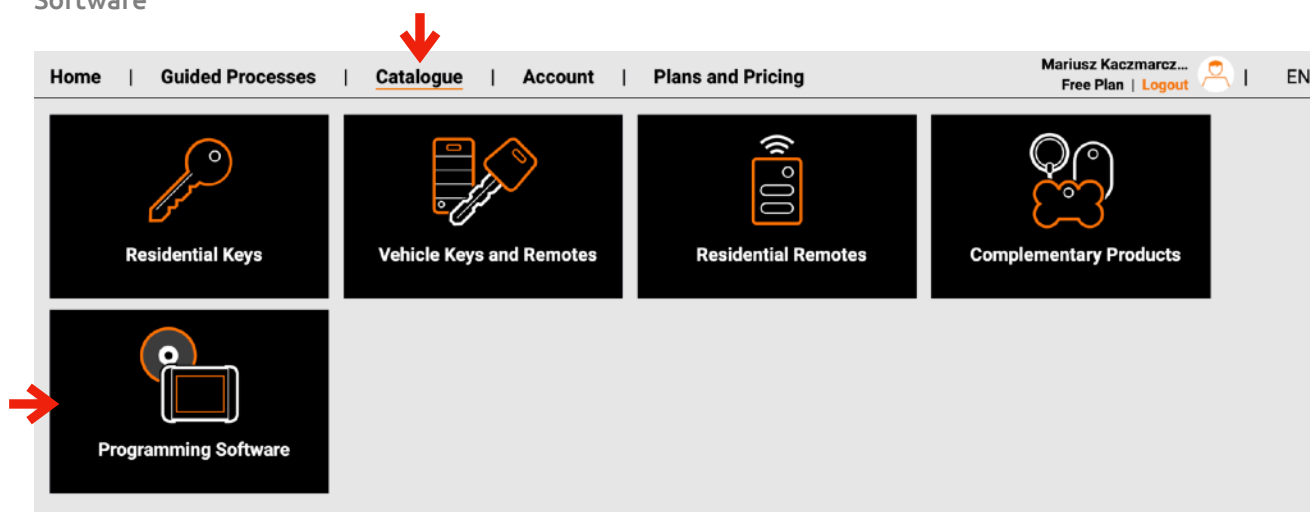

Z menu po lewej należy wybrać interesujące nas oprogramowanie.
Po naciśnięciu Search otworzy się lista obsługiwanych modeli w danym oprogramowaniu.

The screenshot shows the 'Programming Software' interface. On the left, there is a search filter menu with the following options:

- Make: All
- Region: All
- Product Type: All
- Part Number: ADS2261
- Part Number: ADS2261 - Volvo (selected)
- Search button
- Display Result As: Vehicle List

On the right, there is a table of results for the selected part number. The table has the following columns: Model, Variant, Regions, Start-End, Part Number, Engine Code, Engine Size, Fuel Type, Key Type, and Program Transpon. The table contains 8 rows of data, all for Volvo models.

| Model | Variant | Regions | Start-End | Part Number | Engine Code | Engine Size | Fuel Type | Key Type | Program Transpon |
|-------|---------------|---------------------|-------------|-------------|-------------|-------------|-----------|----------|------------------|
| S60 | | AUSTRALIA | 2010 - 2016 | ADS2261 | | | ANY | SLOT | |
| S60 | | AFRICA, EUROPE | 2010 - 2010 | ADS2261 | | | ANY | SLOT | |
| S60 | | CANADA, USA, AFRICA | 2010 - 2016 | ADS2261 | | | PETROL | SLOT | |
| S60 | CROSS COUNTRY | CANADA, USA | 2010 - 2016 | ADS2261 | | | PETROL | SLOT | |
| S60 | CROSS COUNTRY | EUROPE | 2010 - 2016 | ADS2261 | | | ANY | SLOT | |
| S60 | CROSS COUNTRY | AUSTRALIA | 2010 - 2016 | ADS2261 | | | ANY | SLOT | |
| S80 | | AUSTRALIA, EUROPE | 2010 - 2015 | ADS2261 | | | ANY | SLOT | |