

# OPERATION MANUAL FOR TRANSMISSION JACKS

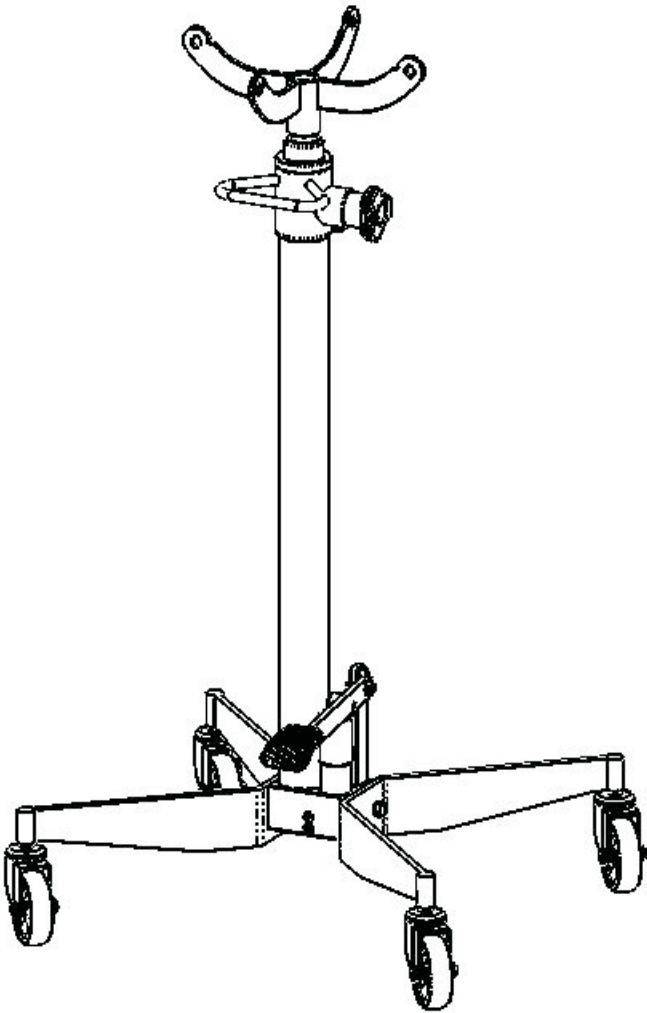

- The product conforms the standard EN 1494:2000/A1:2008
- The product can be used between -20°C~50°C for lifting vehicle.
- The life time of the product: 6~8 years.
- Prohibition of lifting of persons.
- Contact your local refuse disposal authority for more details of how to dispose of your worn-out product. Dispose of the hydraulic oil in an environmentally compatible manner. Ask your local repair garage to see to its disposal or find your nearest waste materials collection centre.
- Please check the spillage of oil before use, if you notice a spillage of oil, stop using the product and absorb the oil with a cloth.
- If the product can not be lowered as wished, the load must be secured by suitable means against unintended lowering. Get a new suitable product, with which you can lift the load, so that the defect product can be repaired or removed and changed. If you are unsure, please ask for professional help.
- It is necessary that the operator can watch the lifting device and the load during all movements;
- It is not allowed to work under the raised load until it is secured by suitable means;
- Need to check the state of the markings and that the markings remain as the initial one;
- Products shall be maintained and repaired in accordance with the manufacturers instructions. Such maintenance and repair shall be carried out by qualified persons;
- No modifications shall be carried out which adversely affect the compliance of the jack with this standard

**⚠ WARNING**

To reduce risk of injury, everyone using, installing, repairing, maintaining, changing accessories on, or working near this tool must read and understand these instructions carefully. Keep them in a safe place for later consultation.





## Safety Instructions

The transmission jack is used for removing, moving and installation of gearbox, transmission box, drive axle or other workpieces.

The transmission jack can only be operated and used by person trained or familiar with this operation manual.

The weight of the workpieces to be removed, moved or installed should never exceed the rated capacity of the transmission jack and those of its accessories, and the lifting height should never exceed the maximum stroke of the jack that is indicated on the label.

This transmission jack can only be supported on a solid, level and horizontal surface that can withstand the load.

Make sure the vehicle is adequately supported and secured before starting maintenance.

Avoid any eccentric placement of workpieces, which may cause overturning or damage of workpieces and transmission jack.

During transportation, please ensure that the piston rod is lowered to the lowest position and the workpiece is placed stably.

Please do not modify the transmission jack in any way, and do not change the safety valve under any circumstances.

Non-compliance with these instructions may result in injury or damage to the user, the transmission jack or the workpiece in the operation.

The manufacturer accepts no responsibility for the improper use of the transmission jack or the damage to the workpiece caused by this improper use.



Lower to the lowest position during transporting.

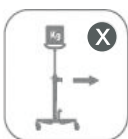

Do not use on inclined and uneven ground



Do not place eccentricly

## Technical Data

Model	Rated load( kg )	A	B	C	D	E	F	N.W. ( kg )
ST1000	1000	1165	840	300	2005	50	600	39.8
ST600	600	1140	840	300	1980	50	600	34.8
ST300	300	1140	860	300	2000	50	600	28.1

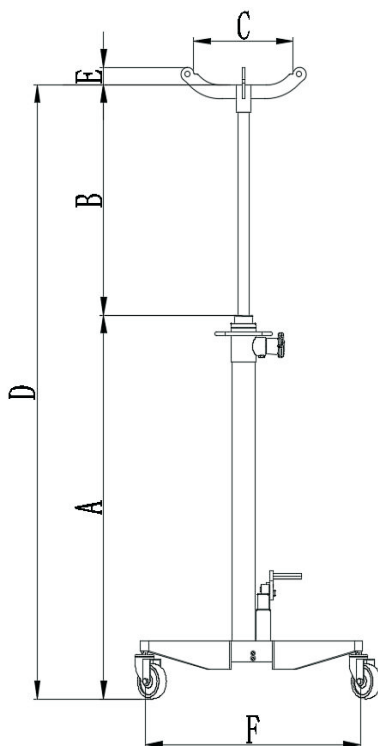

## Part List

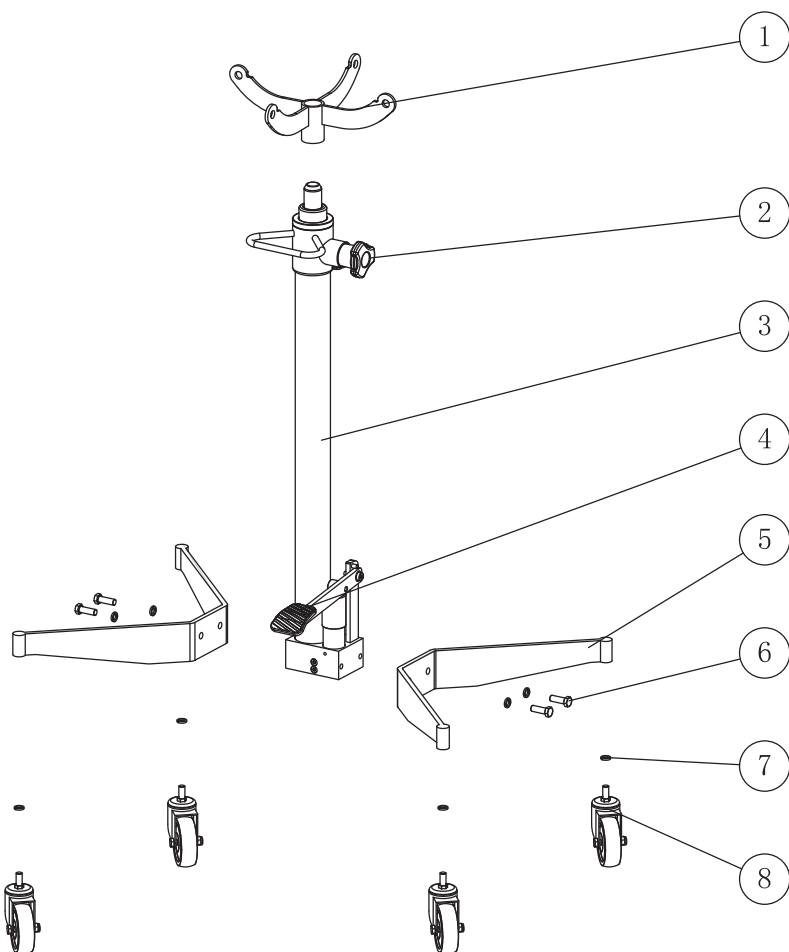

- |   |                      |    |   |                      |    |   |                |    |
|---|----------------------|----|---|----------------------|----|---|----------------|----|
| ① | Bracket assy         | ×1 | ④ | Pump pedal           | ×1 | ⑦ | Spring gaskets | ×8 |
| ② | Pressure relief knob | ×1 | ⑤ | Foot base            | ×2 | ⑧ | Wheel          | ×4 |
| ③ | Oil cylinder         | ×1 | ⑥ | Outer hexagon screws | ×4 |   |                |    |

## Operating Instructions

1. Assembly the wheel, spring gaskets on the foot base and tighten it.
2. The installed foot base is connected to the oil cylinder with screws and spring gaskets, and the screws are screwed into contact with the spring gaskets. When all the four wheels touch the ground, lock the screws in turn;

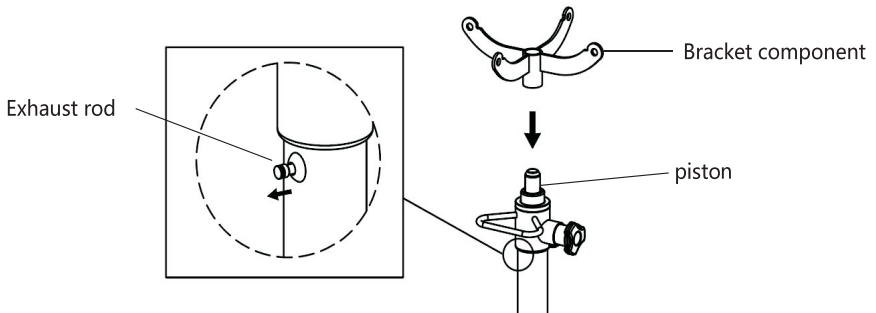
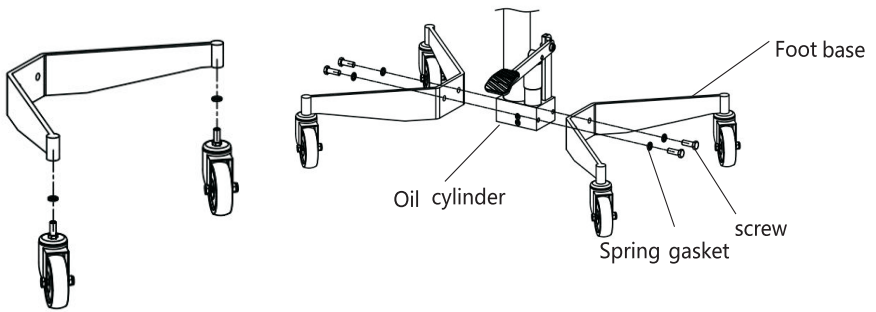

3. Place the bracket component on the piston rod and pull out the exhaust rod as shown

※ Note: Exhaust rod can not completely come out of the rubber plug

Transmission jack's lifting: Step on the oil pump pedal ④

Transmission jack's lowering: rotate the pressure relief knob ② counterclockwise, release the knob, and the pressure relief valve will close automatically.

Transmission jack's movement: before moving lower the transmission jack to the lowest position, and check whether the center of gravity of the load is centered and whether the workpiece is placed stably

## Maintenance Operating

Check whether the parts of the transmission jack are oil leakage, deformation, damage, etc. every day.

The moving parts of the transmission jack shall be lubricated regularly.

This product uses ISO 15#, ISO 22# hydraulic oil, or other hydraulic oil of the same grade. Do not use brake fluid!

The hydraulic oil volume for different models are as follows:

ST1000 : 1.2L

ST600 : 1.0L

ST300 : 0.7L

Professionals shall regularly inspect the transmission jack, check the wear of bracket, foot base and wheels, check whether the seal kits are leaking and whether the safety valve is normal, and confirm that all safety labels are intact, clear and easy to read.

The transmission jack with any form of damage, wear or abnormal operation shall be stopped to use until it is repaired. If the manufacturer or supplier agrees to repair, it is recommended that the manufacturer or supplier's authorized repair organization carry out the necessary repair.

Only use accessories and adapters provided by the manufacturer.

## Troubleshooting guide

1. The jack cannot be lifted to the highest position: check and add hydraulic oil (see maintenance instructions for details)
2. Poor oil pump (empty pump): check whether the exhaust rod is pulled out (see installation instructions for details)
3. Lowering under load (not keeping pressure well): check whether the pressure relief knob is closed tightly.





