

# Grupa HKB

## Pokrętła klamkowe

ze stalowym trzpieniem gwintowanym

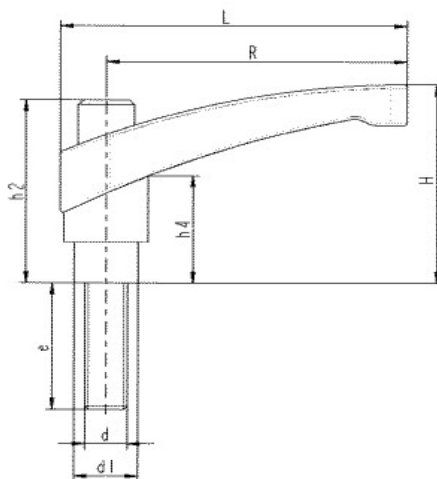

**Materiał:** PA-6, stal

**Kolory standardowe:** czarny

Numer katalog.	R [mm]	d x e [mm]	d1 [mm]	L [mm]	h2 [mm]	H [mm]	h4 [mm]
ALSS43M510S	43	M5 x 10	13,0	51,0	33	37	23
ALSS43M520S	43	M5 x 20	13,0	51,0	33	37	23
ALSS43M615S	43	M6 x 15	13,0	51,0	33	37	23
ALSS43M625S	43	M6 x 25	13,0	51,0	33	37	23
ALSS43M640S	43	M6 x 40	13,0	51,0	33	37	23
ALSS65M615S	65	M6 x 15	15,0	75,0	41	50	26
ALSS65M620S	65	M6 x 20	15,0	75,0	41	50	26
ALSS65M630S	65	M6 x 30	15,0	75,0	41	50	26
ALSS65M640S	65	M6 x 40	15,0	75,0	41	50	26
ALSS65M820S	65	M8 x 20	15,0	75,0	41	50	26
ALSS65M833S	65	M8 x 33	15,0	75,0	41	50	26
ALSS65M847S	65	M8 x 47	15,0	75,0	41	50	26
ALSS65M1020S	65	M10 x 20	15,0	75,0	41	50	26
ALSS65M1030S	65	M10 x 30	15,0	75,0	41	50	26
ALSS65M1040S	65	M10 x 40	15,0	75,0	41	50	26
ALSS85M820S	85	M8 x 20	18,0	98,0	52	65	34
ALSS85M833S	85	M8 x 33	18,0	98,0	52	65	34
ALSS85M847S	85	M8 x 47	18,0	98,0	52	65	34
ALSS85M1020S	85	M10 x 20	18,0	98,0	52	65	34
ALSS85M1030S	85	M10 x 30	18,0	98,0	52	65	34
ALSS85M1040S	85	M10 x 40	18,0	98,0	52	65	34
ALSS85M1230S	85	M12 x 30	18,0	98,0	52	65	34
ALSS85M1240S	85	M12 x 40	18,0	98,0	52	65	34
ALSS85M1260S	85	M12 x 60	18,0	98,0	52	65	34